

1, Church Close,
Market Weighton, YO43 3BD
£195,000

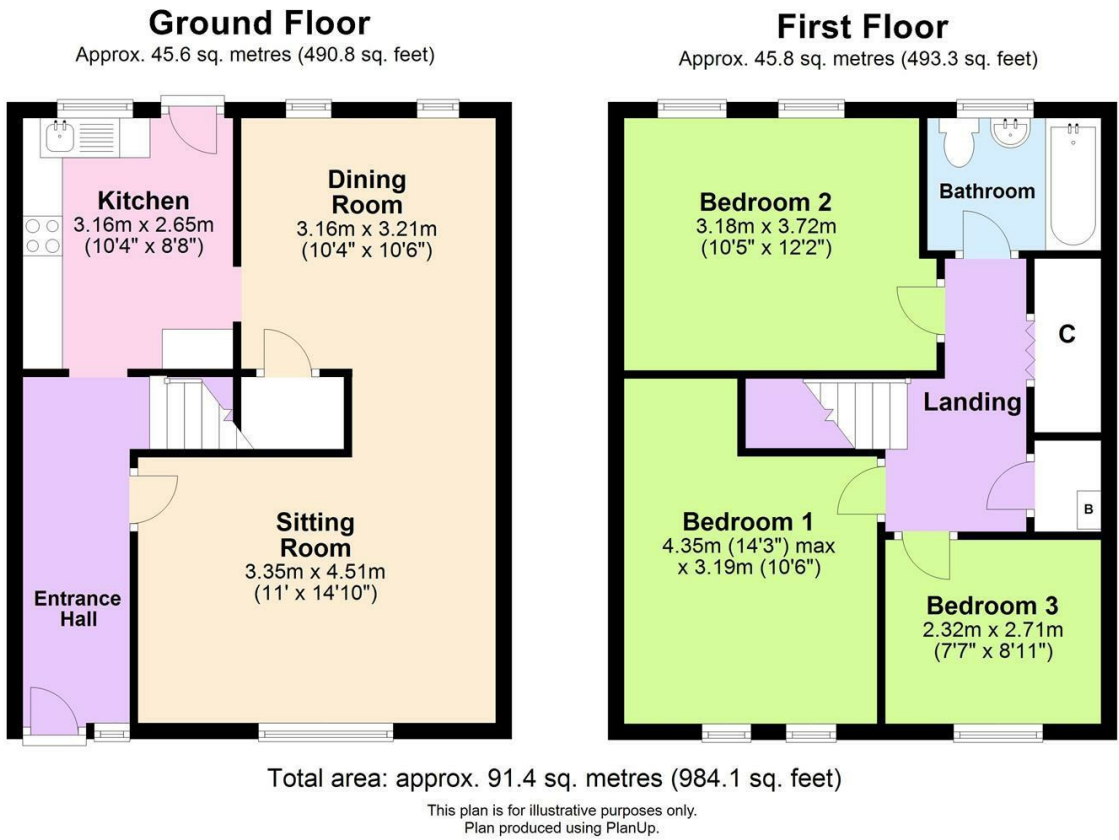

THE ACCOMMODATION COMPRISES**ENTRANCE HALL**

Pvc front entrance door, laminate flooring, radiator, stairs leading to first floor.

SITTING ROOM

3.35m x 4.51m (10'11" x 14'9")

Coal effect gas fire set in marble effect fireplace and hearth with wood surround. Radiator, ceiling coving, TV aerial outlet.

DINING ROOM

3.16m x 3.21m (10'4" x 10'6")

Radiator, ceiling coving, understairs cupboard.

KITCHEN

3.16m x 2.65m (10'4" x 8'8")

Fitted with a range of wall and base units comprising work surfaces, stainless steel sink unit, electric oven with gas hob and extractor over, integrated dishwasher, plumbing for automatic washer, part tiled walls, radiator, PVC rear entrance door.

FIRST FLOOR**LANDING**

Access to loft space (ladder and partially boarded). Two fitted cupboards, one housing wall mounted gas fired central heating boiler.

BEDROOM ONE

4.35m max x 3.19m (14'3" max x 10'5")

Radiator, TV aerial outlet, ceiling coving.

BEDROOM TWO

3.18m x 3.72m (10'5" x 12'2")

Radiator.

BEDROOM THREE

2.32m x 2.71 (7'7" x 8'10")

Radiator.

BATHROOM

Three piece white suite comprising panelled bath with shower over and mixer tap shower attachment, pedestal wash hand basin, low flush WC, part tiled walls.

OUTSIDE

The low maintenance rear garden is mostly gravelled with paved patio area. Brick and fence boundaries provide privacy with side and rear gated access.

Brick store 1.72m x 2.29m. On street parking or alternatively allocated parking to the rear.

ADDITIONAL INFORMATION**SERVICES**

Mains water, gas, electricity and drainage.

APPLIANCES

No appliances have been tested by the agent.

